

# STARTER CLIPS

## SIGNATURE RANGE



To help your Signature composite decking fit flush against a wall or fence, Cladco Signature composite stainless steel starter clips provide a secure and accurate installation. Manufactured from high-quality stainless steel, these starter clips offer increased resistance to wear and tear, ensuring a long-lasting solution for your decking project.



MANUFACTURED FROM  
STAINLESS STEEL FOR A  
DURABLE RESULT



RESISTANT TO CORROSION



EASY INSTALLATION

### T-CLIP AND SCREWS SPECIFICATIONS

SKU	FIXWPCSC
Material	Stainless steel
Pack size	50 (Per pack)
Fixings	M4 x 25mm stainless

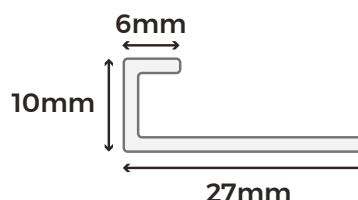
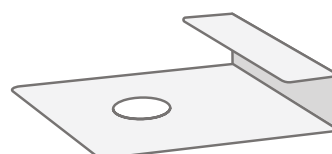

**Please Note:** Images are for illustration purposes only. Actual products may vary slightly from those shown.



## MATERIALS

Signature composite starter clips are made from stainless steel to provide stable fixing for your decking boards.



## SURFACES

These starter clips ensure that the surface of your Signature composite decking is stable and level.



## ACCESSORIES

Can be used alongside the composite T-clips and screws to create a secure and sturdy deck.



## LOW MAINTENANCE

The stainless steel materials means that the starter clips are resistant to corrosion which minimises maintenance.



## LONG-LASTING

These starter clips are resistant to water and corrosion, making them a long-lasting addition to the stability of your decking area.

### Starter Clips

Cladco Signature composite decking starter clips and 50 M4 x 25mm screws ensure a precise and accurate fitting when installing decking boards against a wall or fence.

Installing composite decking correctly from the start is essential. Cladco starter clips help prevent unnecessary adjustments during installation, providing a seamless and secure fixing.

Made from precision-cut stainless steel, Cladco Signature composite decking starter clips are designed for durability. With enhanced corrosion and wear-resistant properties, these clips are built to last for the lifetime of your decking project, offering additional peace of mind.

Each pack contains 50 starter clips and 50 M4 x 25mm screws, with one pack recommended per installation project. For additional guidance, refer to our Signature composite decking installation guide.

These stainless steel starter clips are specifically designed for use with Cladco Signature composite decking products and are not suitable for use with aluminium decking.



Adhering to these guidelines will help ensure proper installation and longevity of your Signature composite decking. Failure to follow these guidelines will invalidate the product's warranty.

## PRODUCT ACCESSORIES



**SIGNATURE  
DECKING BOARDS**



**SIGNATURE  
BULLNOSE BOARDS**

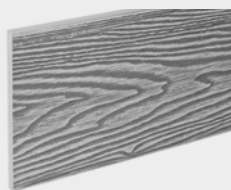

**SIGNATURE FASCIA  
BOARDS**



**SIGNATURE  
T-CLIPS**

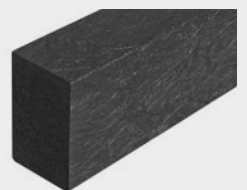

**RECYCLED  
PLASTIC JOISTS**



[www.cladco.co.uk](http://www.cladco.co.uk)

**T:** 01837 659901 **E:** [info@cladco.co.uk](mailto:info@cladco.co.uk)

**CLADCO**  
PROFILES